

TOKii 301

Flap Barrier

Description

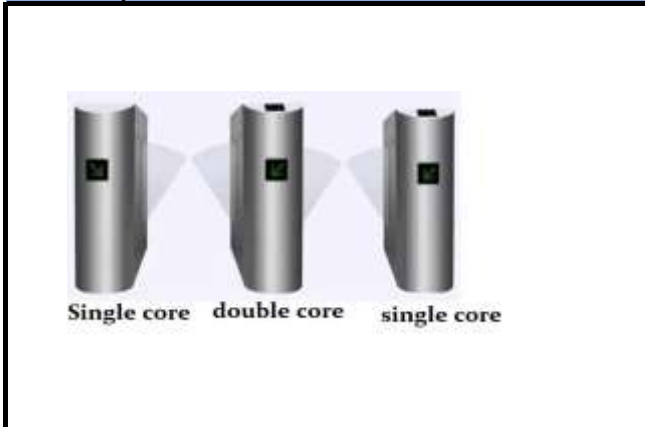

Access control 304 stainless steel flap barrier is the intelligent channel management equipment. This equipment integrates mechanical, electronic, microprocessor control and various read-write technologies organically. Flap barrier intelligent control and management channels, configuration of various read-devices, reliable security devices, real time alarm system and direction indicating interface. The material used 304 stainless steel which is rustproof, durable and clean appearance, the standard electric interface is adapted to the outside, so the barcode card, ID card, IC card and other readers can be easily integrated into the equipment, it provides a civilized and orderly way for people to go in and out, and at the same time, it can prevent illegal people from going in and out. In addition, the system has been specially designed to meet the fire control requirements, so as to ensure that the passage is unimpeded in case of emergency for immediate evacuation.

Features :

1. It has the zero self-check function, which is convenient for users to maintain and use ;
2. Illegal entry with warning function .
3. Anti-impact function,when not receive open signal instructions,the telescopic baffle(swing arm) automatically locks up.
4. Infrared /Mechanical Double anti-clamp function,when the retractable baffle (swing arm) is in the process of resetting,the motor automatically stops working within the prescribed time, and the force is very small, and at the same time,the alarm signal is issued .
- 5.It has the function of automatic reset.If the pedestrian reads the valid card,the system will automatically cancel the right of passage if the pedestrian does not pass within the time specified in the system .

Technical Data

Dimension excluding bars	mm	1200x 300x 980
Technical Data	Unit	TOKii-301
Passage width	mm	600
Throughput rate	p/m	35
power supply	V(ac)	100-240
Operational voltage	V(ac)	24
Max power consumption	w	35
Frequency	hz	50~60
Protection level	ip	>44
working temperature	°C	-25-+70
Electro- magnetic drive		DC
use environment		indoor, outdoor
net weight including bars	kg	75

with various card readers, and can be controled and managed remotely by management computer .

7. The whole system runs smoothly with low noise .

Operating Modes

- 1.Single passage in the set direction
- 2.Bi- directional single passage
3. Free passage in the set direction
4. Always free or locked

Material

- 1.Flapp barrier body made in metal 304 stainless steel .
- 2.Barrier swings - Plastic plate (toughened glass or stainless steel for option)
3. Lid - stainless steel

Advantage

- 1.Control board

The gear rotation system is used to lock the gate in the zero position, the unlocking is more stable and reliable, the function is complete,the door control and the consumption function are provided, and the gate can be controlled at the same time, no external consumption system is needed .

- 2.Acrylic wing arm

The system automatically reset the gate when the value is not open within the specified time after opening the gate to ensure the safety of the channel.

- 3.Card window

With a variety of working modes, you can swipe the card while the button is open

- 4.Material (good quality)

Used 304 stainless steel. And thickness is not less than 1.5mm.

5. Equipment (quality control by ourselves)

from raw material - laser cutting- bend - planer -welding

TOKii-301

Flap Barrier

Application

- 1.office space :comercial buildings ,government offices etc
- 2.All factory :Electronics factories. Cleanroom,esd area etc
- 3.science unit : universities ,research institutes , libraries etc
- 4.commercial service establishment: supermarkets, banks..
- 5.Leisure and entertainment: parks , scenic areas.layground
- 6. Transportation sites : subway stations, airport and so on

Access control system

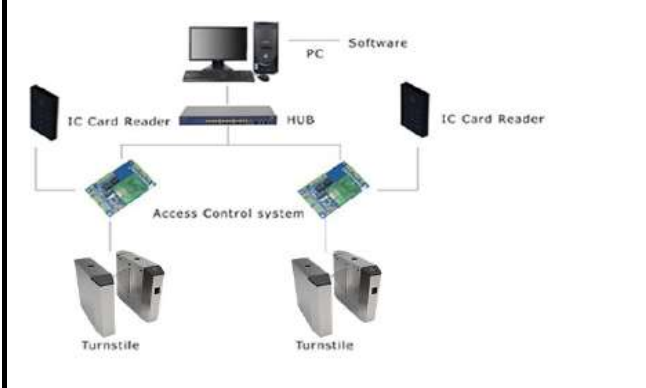

Flap barrier drawing

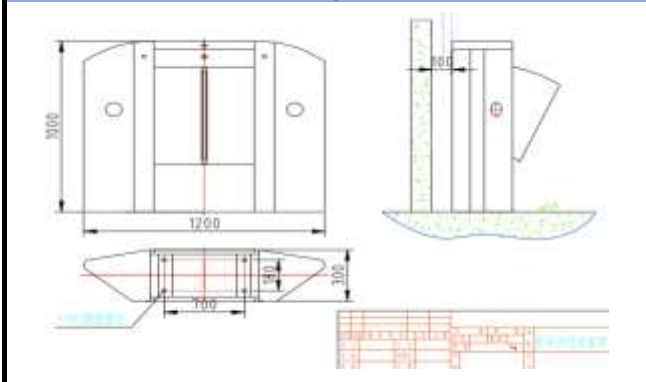

Installation

On channel brake installation is very simple, just put the fixed well,main machine and insert 110V/220V power supply,can normal use, if you need to connected with internet,only need use a network line can be received from the main computer, we will provide all the one -on one phone guidance services .

E- ticketing system



Terminal connection

