

# DESOLDERING PRODUCTS

## DESOLDERING PRODUCTS

SERVICE STATION

AUTOMATIC DESOLDERING STATION

PORTABLE DESOLDERING GUNS

DESOLDERING WICKS

DESOLDERING SUCKERS



**Omnifunctional machine for soldering, desoldering and reworking.**

SERVICE STATION

**SVS-800AS**

### REWORK UNIT

The temperature can be set to max 550°C.

### SOLDERING UNIT

Good for a wide range of soldering work with 70 W heater.

### DESOLDERING UNIT

Instant desoldering with open-valve mechanism. (Please refer to the next page.)

### INDIVIDUAL POWER SWITCHES

Along with the main power switch, there are switches for soldering, desoldering, and reworking.

### INDEPENDENT PUMPS

Desoldering and reworking operate simultaneously

### 400% MORE SUCTION CAPACITY

With open-valve mechanism

### CERAMIC HEATER WITH INTERNAL SENSOR

A wide range for terminals, connectors and flat ICs (soldering & desoldering)

### SUPERIOR TEMPERATURE-CONTROL CIRCUIT

To keep the temperature constant during desoldering

### ZERO VOLT SWITCH CIRCUIT

Reduces noise during heater ON/OFF

### REPLACEABLE CARTRIDGE FILTER

Makes changing the filter easy



Nozzles sold separately.

**RoHS** **ANTI STATIC** **LEAD FREE**

**Desoldering in an instant, with reduced solder residue! Combines desoldering gun and temperature-controlled soldering iron in one unit.**

SERVICE STATION

**SVS-580AS**



**400% MORE SUCTION CAPACITY**  
With open-valve mechanism

**CERAMIC HEATER WITH INTERNAL SENSOR**  
A wide range for terminals, connectors and flat ICs

**SUPERIOR TEMPERATURE-CONTROL CIRCUIT**  
To keep the temperature constant during desoldering

**ZERO VOLT SWITCH CIRCUIT**  
Reduces noise during heater ON/OFF

**REPLACEABLE CARTRIDGE FILTER**  
Makes changing the filter easy

**RoHS** **ANTI STATIC** **LEAD FREE**

## PRODUCT SPECIFICATIONS / FUNCTIONS

### TIP/NOZZLE TEMPERATURE-RECOVERY FEATURES

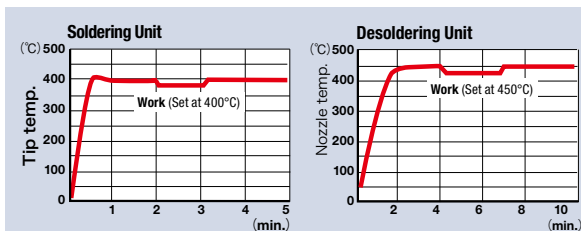

Solder melted consecutively on 5 mm-dia land. Approx. 2 s / land.  
(with **PX-2RT-B** tip, **TP-100N-10** nozzle)

The open-valve allows the device to reach vacuum pressure of -0.06MP (approx. -450 mmHg) in only 0.1second. (about 4 times faster than our **SVS-500AS**).

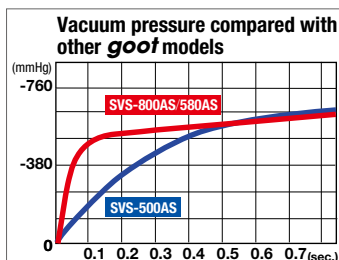

### SUCTION CAPACITY COMPARISON

The arrow indicates solder residue.



### OPEN-VALVE MECHANISM

Two-stage trigger switch (PAT.P)

#### Step 1

Pulling the trigger (lightly) activates the first stage switch. The pump starts, and the air pressure decreases in the vacuum chamber.

#### Step 2

Next, pulling the trigger fully activates the second stage. The open-valve will open, and the solder is sucked up at once by the negative pressure in the vacuum chamber.

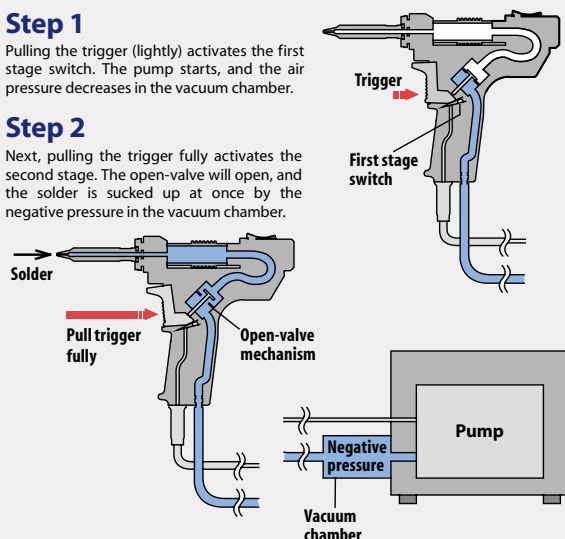

### SPECIFICATIONS

MODEL	SVS-800AS	SVS-580AS
Voltage	220-240 V AC 50/ 60 Hz	110 V,120 V, 220-240 V AC 50/ 60 Hz
Power Consumption	670-760 W	200 W (110 V,120 V) 270-300 W (220-240 V)
Power Cord Length	1.5 m Inlet type	1.5 m
Temp. Range	Desoldering Unit: 250-450°C Soldering Unit: 200-480°C Rework: 150-550°C	250-450°C 200-480°C
Insulation Resistance	Over 10 MΩ (500 V DC)	Over 100 MΩ (500 V DC)
Vacuum Pump System	Diaphragm system	Diaphragm system
Vacuum	- 0.08 MPa (-600 mmHg)	- 0.08 MPa (-600 mm Hg)
Air Flow	5-25L /min	-
Accessories	Cleaning pin <b>TP-100CP-13/</b>	Soldering iron stand <b>ST-76</b>
Total Weight	9.3 kg	4.0 kg

### CONTROL BOX

Output Voltage	220-240 V AC	110 V,120 V, 220-240 V AC
Dimensions	405 (W) × 240 (H) × 235 (D) mm	205 (W) × 170 (H) × 160 (D) mm
Weight	8.4 kg (w/o cord, hose )	3.6 kg (w/o cord, hose )

### DESOLDERING UNIT

Input Voltage	220-240 V AC	110 V,120 V, 220-240 V AC
Power Consumption	85 W	85 W
Heater	Ceramaic Heater	Ceramaic Heater
Cord Length	1.2 m	1.2 m
Dimensions	220 x 155 mm	220 x 155 mm
Weight	250 g (w/o cord, hose )	250 g (w/o cord, hose )
Standard Nozzle	<b>TP-100N-S5</b>	<b>TP-100N-S5</b>

### SOLDERING UNIT

Input Voltage	220-240 V AC	110 V,120 V, 220-240 V AC
Power Consumption	70 W	70 W
Ground Resistance	Less than 2 Ω	Less than 2 Ω
Leak Voltage	Under 2 mV	Under 2mV
Heater	Ceramic heater	Ceramic heater
Cord Length	1.2 m	1.2 m
Length	190 mm (with <b>PX-2RT-B</b> )	190 mm (with <b>PX-2RT-B</b> )
Weight	70 g (with <b>PX-2RT-B</b> )	70 g (with <b>PX-2RT-B</b> )
Standard Tip	<b>PX-2RT-B</b>	<b>PX-2RT-B</b>

### REWORK UNIT

Input Voltage	220-240 V AC	-
Power Consumption	370-430 W	-
Heater	Nichrome Heater	-
Hose length between Handpiece and Control Unit	1 m	-
Length	220 mm (w/o cord)	-
Weight	180 g (w/o nozzle, cord)	-

This machine does not have vacuum pickup function.

For replacement tips, nozzles, and optional parts, refer to **p.54** & **p. 63**



**ST-76**  
soldering iron stand  
(included)